

无刷直流行星齿轮减速电机 (内齿圈材质:金属)
BLDC Planetary Gear Motor (Ring Gear Material: Metal)

60JX450K/57ZWN95

Φ60行星减速器, 允许转矩范围:2N.m~45N.m
60mm OD Planetary Gearbox,
Permissible Load Range: 2N.m~45N.m

外形和安装尺寸

Dimensions

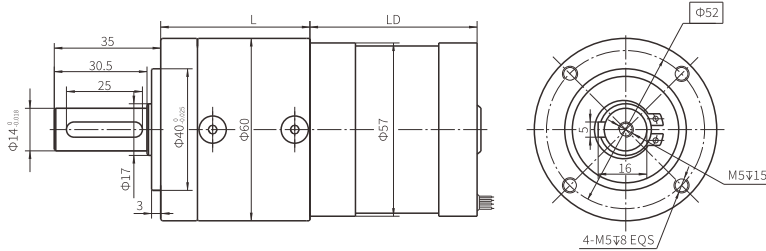

无刷电动机主要技术参数

Brushless Motor Technical Data

| 电机型号 Type | 极数 Number of poles | 相数 Number of phase | 额定电压 Rated Voltage VDC | 空载转速 No-load Speed r/min | 额定转速 Rated Speed r/min | 额定转矩 Rated Torque N.m | 额定功率 Rated Power W | 额定电流 Rated Current A | 峰值转矩 Peak Torque N.m | 峰值电流 Peak Current A |
|--------------|-----------------------|-----------------------|---------------------------|-----------------------------|---------------------------|--------------------------|-----------------------|-------------------------|-------------------------|------------------------|
| 57ZWN95-2420 | 8 | 3 | 24 | 2000 | 1450 | 0.38 | 60 | 3.47 | 0.76 | 6.94 |
| 57ZWN95-2430 | 8 | 3 | 24 | 3000 | 2000 | 0.38 | 80 | 4.63 | 0.76 | 9.26 |

无刷行星齿轮减速电机主要技术参数

Brushless Gear Motor Technical Data

配置57ZWN95-2420无刷直流电机(57ZWN95-2420 BLDC Motor)

| 减速比 Reduction ratio | 4 | 5 | 8 | 12 | 16 | 20 | 32 | 40 | 64 | 80 | 100 | 120 | 160 |
|---|------|------|------|------|------|------|------|------|------|------|------|------|------|
| 减速级数 Number of gear trains | 1 | 1 | 1 | 2 | 2 | 2 | 2 | 2 | 3 | 3 | 3 | 3 | 3 |
| 减速器长度(L) Length mm | 49.1 | 49.1 | 65.6 | 65.6 | 65.6 | 65.6 | 65.6 | 65.6 | 82.1 | 82.1 | 82.1 | 82.1 | 82.1 |
| 空载速度 No-load speed r/min | 500 | 400 | 250 | 167 | 125 | 100 | 63 | 50 | 31 | 25 | 20 | 17 | 13 |
| 额定转速 Rated speed r/min | 363 | 290 | 181 | 121 | 91 | 73 | 45 | 36 | 23 | 18 | 15 | 12 | 9 |
| 额定转矩 Rated torque N.m | 1.4 | 1.7 | 2.7 | 3.7 | 4.9 | 6.2 | 9.8 | 12.3 | 17.7 | 22.2 | 27.7 | 33.2 | 45.0 |
| 最大瞬间允许负载 Max. permissible load in a short time N.m | 5 | 5 | 5 | 5 | 5 | 5 | 5 | 5 | 5 | 5 | 5 | 5 | 5 |

配置57ZWN95-2430无刷直流电机(57ZWN95-2430 BLDC Motor)

| 减速比 Reduction ratio | 4 | 5 | 8 | 12 | 16 | 20 | 32 | 40 | 64 | 80 | 100 | 120 | 160 |
|---|------|------|------|------|------|------|------|------|------|------|------|------|------|
| 减速级数 Number of gear trains | 1 | 1 | 1 | 2 | 2 | 2 | 2 | 2 | 3 | 3 | 3 | 3 | 3 |
| 减速器长度(L) Length mm | 49.1 | 49.1 | 65.6 | 65.6 | 65.6 | 65.6 | 65.6 | 65.6 | 82.1 | 82.1 | 82.1 | 82.1 | 82.1 |
| 空载速度 No-load speed r/min | 750 | 600 | 375 | 250 | 188 | 150 | 94 | 75 | 47 | 38 | 30 | 25 | 19 |
| 额定转速 Rated speed r/min | 500 | 400 | 250 | 167 | 125 | 100 | 63 | 50 | 31 | 25 | 20 | 17 | 13 |
| 额定转矩 Rated torque N.m | 1.4 | 1.7 | 2.7 | 3.7 | 4.9 | 6.2 | 9.8 | 12.3 | 17.7 | 22.2 | 27.7 | 33.2 | 45.0 |
| 最大瞬间允许负载 Max. permissible load in a short time N.m | 5 | 5 | 5 | 5 | 5 | 5 | 5 | 5 | 5 | 5 | 5 | 5 | 5 |

接线方式

Wire Diagram

| U | V | W | Vcc | Ha | Hb | Hc | GND |
|----------|---|---|---------|----|----|----|-----|
| 电机 Motor | | | 霍尔 Hall | | | | |