

永磁直行星齿轮电机 (内齿圈材质: 金属)

PM DC Planetary Gear Motor (Ring Gear Material: Metal)

**42JX150K/42ZY85** Φ42 加强型减速器, 允许转矩范围: 2N.m~15N.m  
 42mm OD Reinforced Gearbox, Permissible Load Range: 2N.m~15N.m

● 外形和安装尺寸 Dimensions

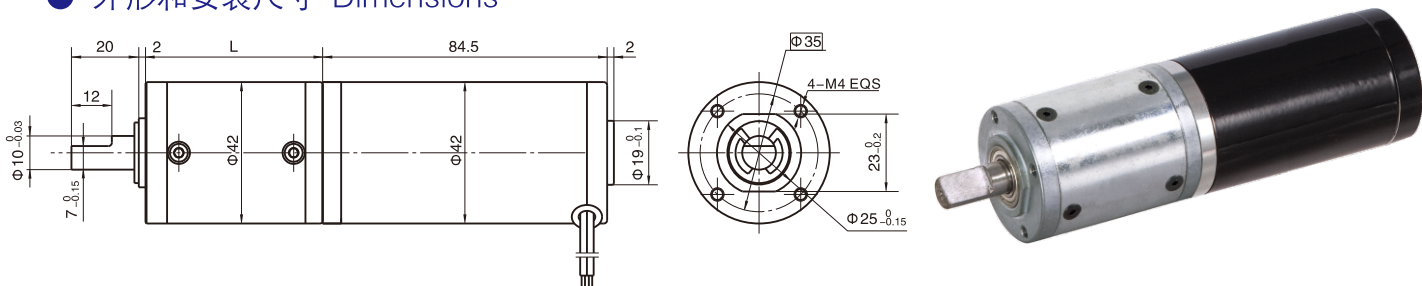

● 电动机主要技术参数 Motor Technical Data

电机型号 TYPE	额定电压 Rated voltage VDC	空载转速 No-load speed r/min	空载电流 No-load current A	额定转速 Rated speed r/min	额定转矩 Rated torque mN.m	输出功率 Output power W	额定电流 Rated current A	堵转力矩 Stall torque mN.m	堵转电流 Stall current A
42ZY85-2430	24	3000	0.20	2400	70	15	1.2	280	3.7
42ZY85-2436	24	3600	0.30	2850	80	23	1.5	290	4.7

● 齿轮减速电机主要技术参数 Gear Motor Technical Data

配置42ZY85-2430直流电机 (42ZY85-2430 DC Motor)

减速比 Reduction ratio	3.5	14	17	21	49	61	84	104	126	172	212	294
减速级数 Number of gear trains	1	2	2	2	3	3	3	3	3	4	4	4
减速器长度(L) Length(L) mm	32.5	39.2	39.2	39.2	46	46	46	46	46	52.5	52.5	52.5
空载转速 No-load speed r/min	857	214	176	143	61	49	36	28	24	17	14	10
额定转速 Rated speed r/min	686	171	141	114	49	39	29	23	19	14	11	8
额定转矩 Rated torque N.m	0.22	0.79	0.96	1.2	2.5	3.1	4.2	5.3	6.4	7.9	9.8	13
最大瞬间允许负载 Max. permissible load in a short time N.m	3	12	12	12	25	25	25	25	25	30	30	30

配置42ZY85-2436直流电机 (42ZY85-2436 DC Motor)

减速比 Reduction ratio	3.5	14	17	21	49	61	84	104	126	172	212	294
减速级数 Number of gear trains	1	2	2	2	3	3	3	3	3	4	4	4
减速器长度(L) Length(L) mm	32.5	39.2	39.2	39.2	46	46	46	46	46	52.5	52.5	52.5
空载转速 No-load speed r/min	1028	257	211	171	73	59	43	34	28	21	17	12
额定转速 Rated speed r/min	814	203	167	136	58	48	34	27	22	16	13	10
额定转矩 Rated torque N.m	0.25	0.90	1.1	1.3	2.8	3.5	4.9	6.0	7.3	9.0	11	15
最大瞬间允许负载 Max. permissible load in a short time N.m	3	12	12	12	25	25	25	25	25	30	30	30

● 电动机特性图 Motor Characteristic Figure

